

Fibre optic connectors shown in the figure,
Support 10mm effective optical fiber.

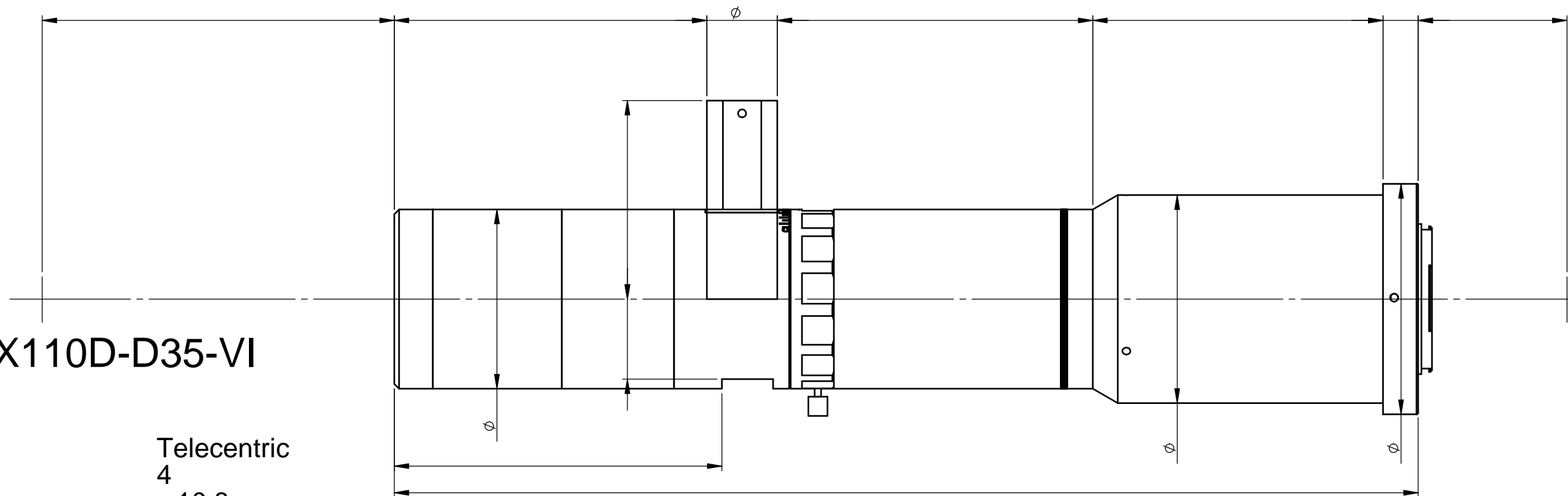
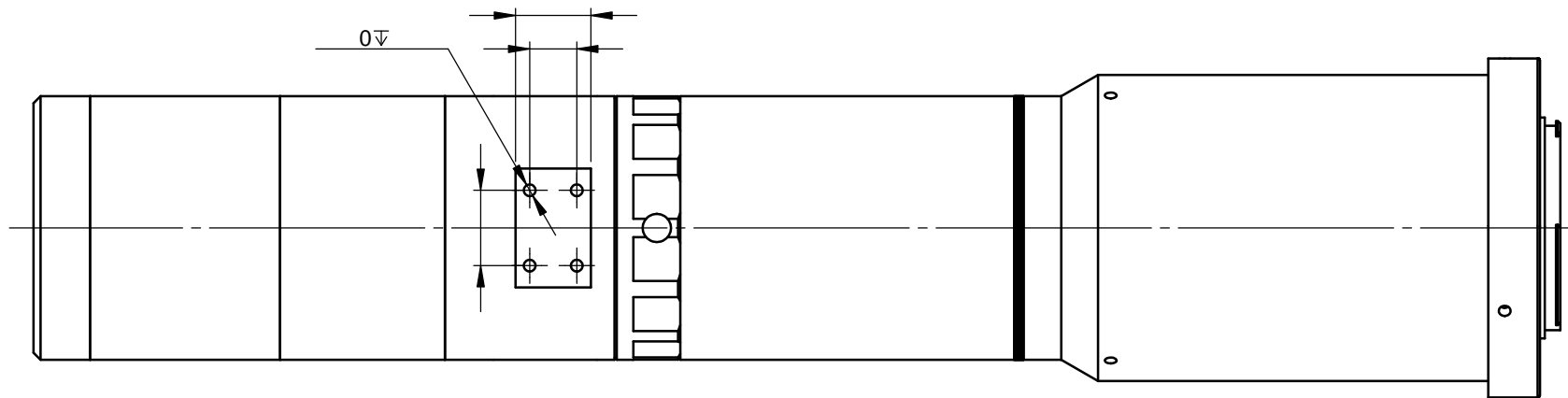

XF-MDT4X110D-D35-VI

Specifacaiton

Optical structure	Telecentric
Magnification	4
Object field of view	- 10.8mm
Image field of view	- 43.3mm
Working Distance	110mm±3%
Telecentricity	<0.08°
Depth of field	0.11—1.9mm
F#	F16.9—201.1
Resolution	2.8—50 m
MTF	>0.3@60—3.5lp/mm
Distortion	<0.075%
Detector type	CCD

35film 36x24	9x6mm
4/3' 18x13.5	4.5x3.4mm
1' 12.8x9.6	3.2x2.4mm
2K Linear scan 2048x1440	7.2mm
4K Linear scan 4096x720	7.2mm
6K Linear scan 6144x720	10.8mm
8K Linear scan 8192x3500	7.2mm

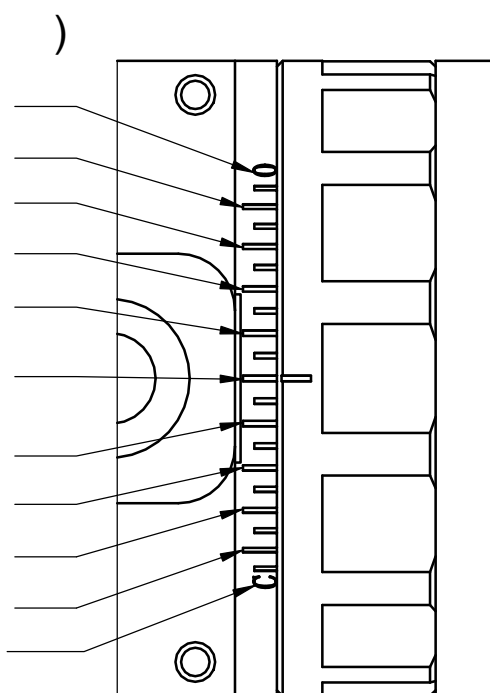

8 QGHILQHG WROH	GHQJHHP) LOH 1DPH
; ;	f PLQ	;) 0'7 ; ' ' 9, F'j((1
; ; ;	f	'UDZLQJ 1DPH
; ; ; ;	f	'UDZLQJ 6L]HÖ\$
	6LJQ	'DWD 9HU 0DWHULDQDWLR 3URGXFW 1DPH
'HVLJQ		
ORGL \		4W \ ⊕ &DQULOO
ORGL \		7RWDO 3DJH